

GUCCI

G-FRAME HOW TO  
Replacing the Interchangeable Strap

## REMOVE THE STRAP

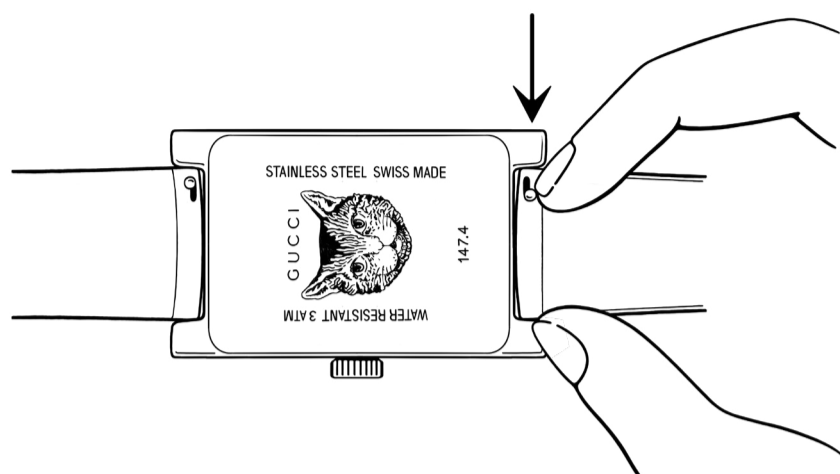

### 1. PULL DOWN THE SPRING BAR

On the back of your G-Frame watch, you will find a quick-release spring bar on each side of the strap, pull down to release the strap from the watch case.

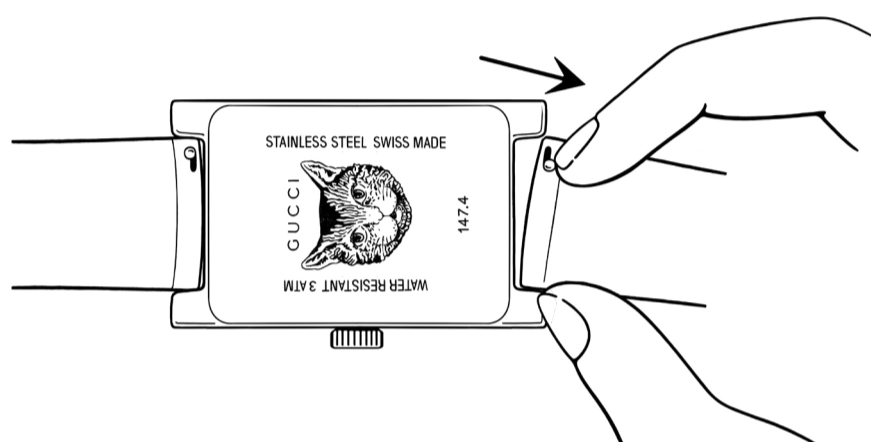

### 2. TILT THE STRAP

While keeping the spring bar down, gently tilt the strap away from the watch case.

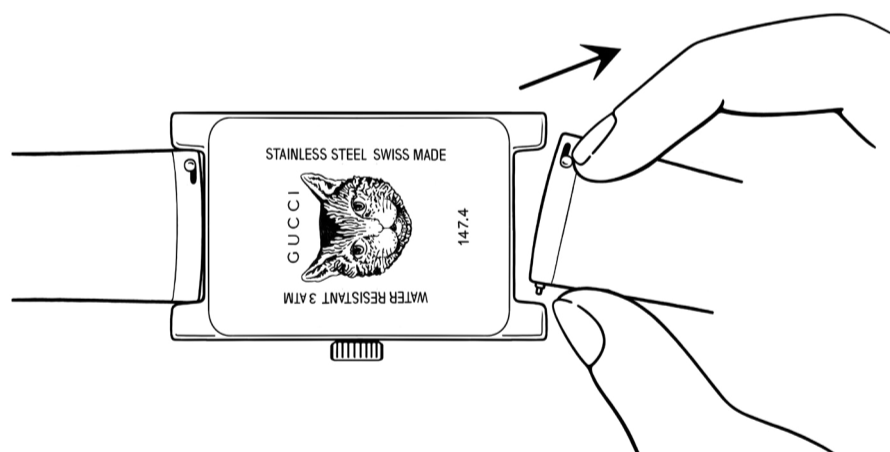

### 3. LIFT THE STRAP UP AND DETACH IT

Keep the spring bar down and slightly lift the strap to fully detach it from the case.



### 4. RELEASE THE SPRING BAR AND REMOVE

Finally, release the spring bar and remove the strap you wish to replace.

## REPLACE THE NEW STRAP

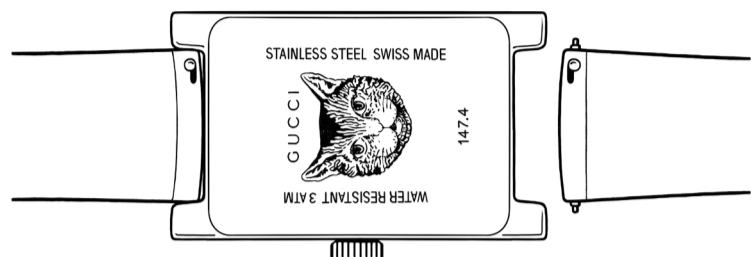

### 5. FIND THE SPRING BAR

Select your new G-Frame strap and turn it to the back, where the quick-release spring bar is placed.

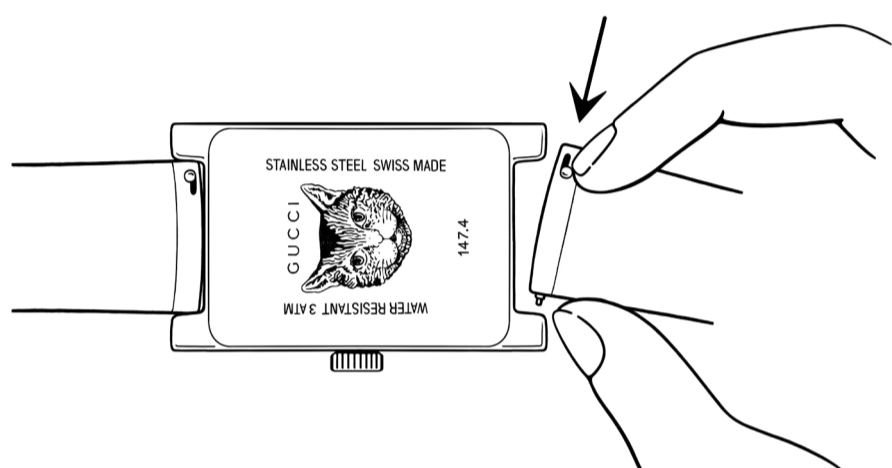

### 6. PULL DOWN THE SPRING BAR

Pull down the spring bar, slightly tilt the strap and move it towards the watch, clicking one side into the case.

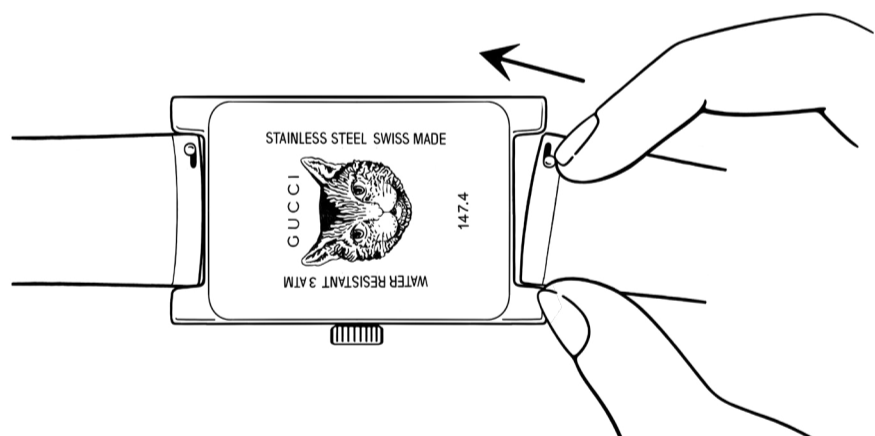

### 7. PRESS THE STRAP DOWN AND ATTACH IT

Keeping the spring bar down, move the strap towards the case and attach the other end to the watch.

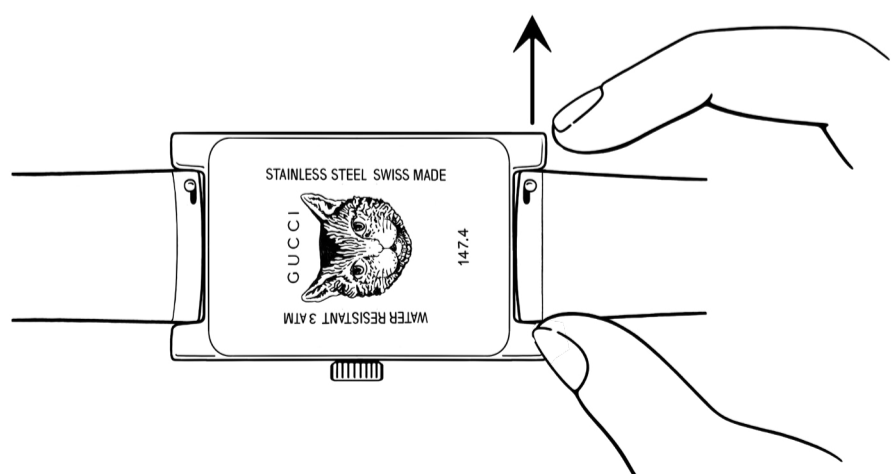

### 8. RELEASE THE SPRING BAR AND SECURE

Finally, release the spring bar, securing the new strap to your G-Frame watch.